

Create With Claudia Mystery Quilt Along 2020

Use a scant $\frac{1}{4}$ inch seam allowance

Fabric requirements listed are generous • Arrows indicate pressing direction

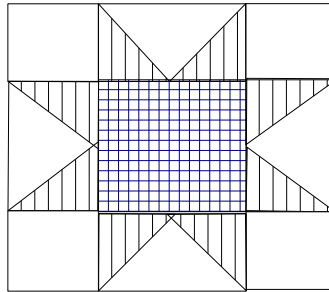

Cutting instructions are for all of the blocks needed for the month

April Block - Sawtooth Star



This month is all about the well-known Sawtooth Star block and you will be making two of them. Both will be $6\frac{1}{2}$ inches by $6\frac{1}{2}$ inches when completed.

Fabric Requirements

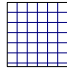
Fabric A  - 15" square * Fabric B  - 11" square * Fabric C  - 7" square

Cutting (For All Blocks)

Fabric A 8 Squares – 2 inches by 2 inches
 2 Squares – $4\frac{1}{4}$ inches by $4\frac{1}{4}$ inches

Fabric B 8 Squares – $2\frac{1}{2}$ inches by $2\frac{1}{2}$ inches

Fabric C 2 Squares – $3\frac{1}{2}$ inches by $3\frac{1}{2}$ inches

Block Assembly

Assemble the Geese (You will need one of the $4\frac{1}{4}$ inch squares and four of the $2\frac{1}{2}$ inch squares.)

First – Draw a diagonal line on the back(wrong) side of the four small squares.

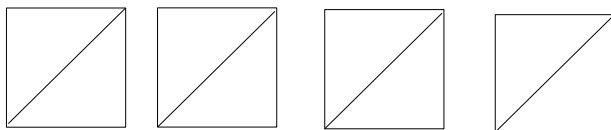

Create With Claudia Mystery Quilt Along 2020

Use a scant $\frac{1}{4}$ inch seam allowance

Fabric requirements listed are generous • Arrows indicate pressing direction

Cutting instructions are for all of the blocks needed for the month

Next – Line up one of the small squares on top of the large square with right (front) sides facing. Line up another small square on the opposite corner.

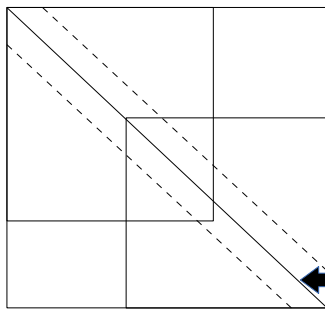

Using a scant $\frac{1}{4}$ inch seam allowance, sew down each side of the line drawn.

Cut along the line that was previously drawn and press open, so that you have two units like this.

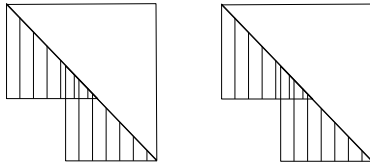

Using one of these units, take another one of the $2\frac{1}{2}$ inch squares and line it up on the remaining corner (right sides facing).

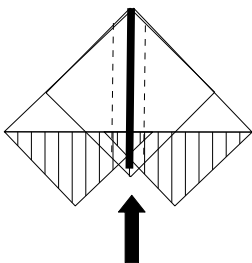

Using a scant $\frac{1}{4}$ inch seam, sew along both sides of the drawn line.

Cut along drawn line, press open. You will have two flying geese units. If needed, trim them down to the size needed: 2 inches by $3\frac{1}{2}$ inches.

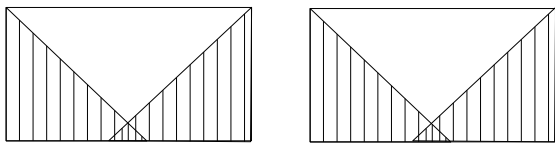

Repeat all steps to get two more Flying Geese units. You should have four total.

2020 ©Create with Claudia * All Rights Reserved * Written permission is needed to duplicate and may not be used for commercial purposes * Best efforts have been made to ensure that the instructions are correct, however sometime errors occur.

If you have any questions, please contact us at claudia@createwithclaudia.com

www.createwithclaudia.com

Create With Claudia Mystery Quilt Along 2020

Use a scant ¼ inch seam allowance

Fabric requirements listed are generous • Arrows indicate pressing direction
Cutting instructions are for all of the blocks needed for the month

Block Assembly

Lay out your units as follows:

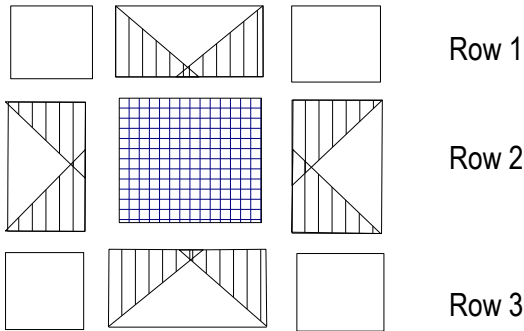

Sew together the left and center units of row one. Repeat with row 2 and 3.

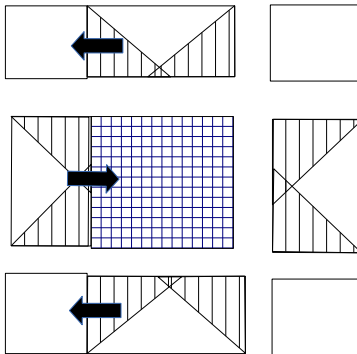

Add the right unit to each row. Finally, sew the rows together, press open and you have your completed block.
The blocks should measure 6 ½ inches by 6 ½ inches.

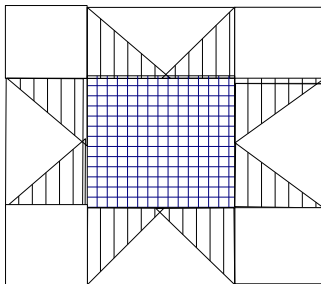

Repeat process. You will have two completed sawtooth star blocks.

Clue: Bears love to roam the woods, but look out for those big paws!

2020 ©Create with Claudia * All Rights Reserved * Written permission is needed to duplicate and may not be used for commercial purposes * Best efforts have been made to ensure that the instructions are correct, however sometime errors occur.

If you have any questions, please contact us at claudia@createwithclaudia.com

www.createwithclaudia.com